

- I Prima di iniziare il montaggio, identificare tutti i componenti con l'aiuto delle istruzioni.
- GB Before starting to assembly, please identify all components.
- D Vor der montage, sind die Einzelteile anhand der Montageanleitung zu identifizieren.
- F Avant de débiter le montage, identifiez tous les composants a l'aide de la notice.
- E Antes de iniciar el montaje, identifique todos los componentes con ayuda de la nota.

Attenzione-Attention-Vorsicht-Attention-Atención

- I Si consiglia di effettuare il montaggio su una superficie morbida.
- GB It is a good idea to use a soft protective underlay during assembly.
- D Möbelteile auf eine weiche Oberfläche legen und dann aufstellen.
- F Veuillez poser les pièces sur un surface souple pour l'assemblage.
- E Se aconseja efectuar el montaje sobre una superficie blanda.



- I Pezzo di ricambio.
- GB Spare part.
- D Ersatzteil.
- F Pièce en échange / s.a.v.
- E Repuesto

H-A 3414 01 00-0

calligaris

ASSOCIATO A
FLA
 ASSARREDDO
 ASSOCIAZIONE TECNICI ED INGEGNERI
 icma ISO 9001
 Calligaris S.p.A.
 Via Trieste, 12
 33044 Manzano
 (Udine) Italy
 Tel. +39 0432 748211
 calligaris.com

Copyright © Calligaris S.p.a. Tutti i diritti riservati - All right reserved

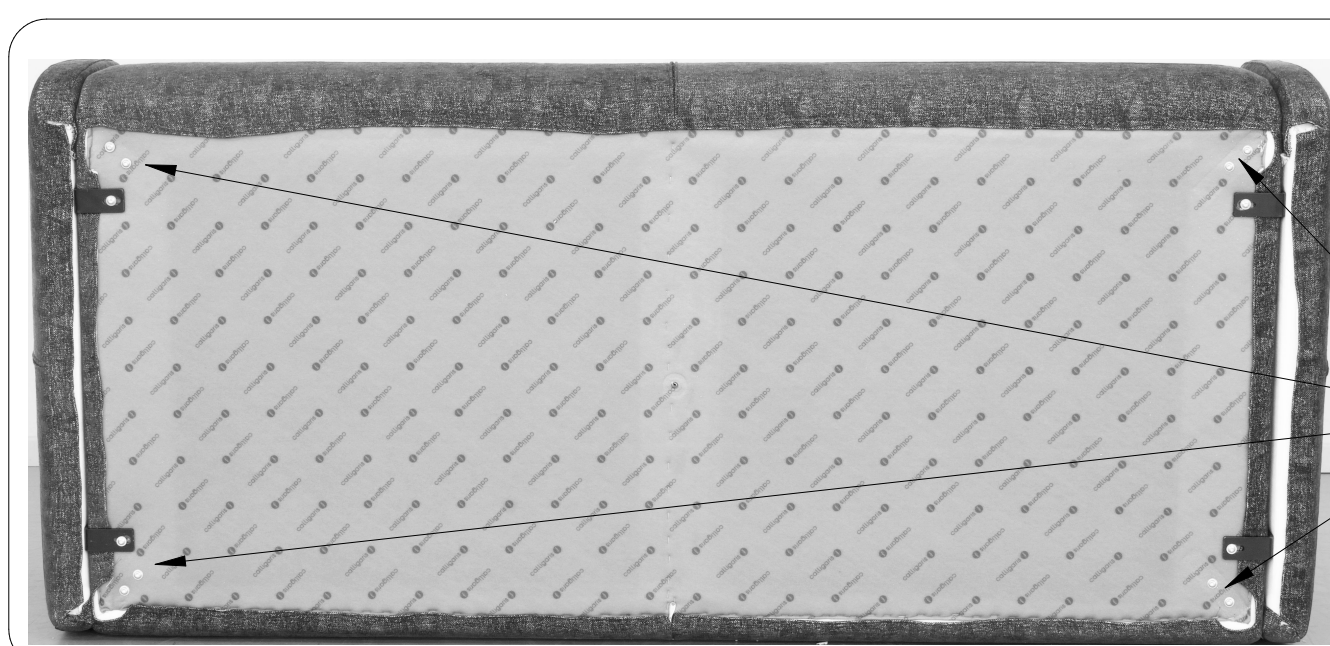

1

- I Svitare le viti.
 - GB Unscrew the screws.
 - D Lösen Sie die Schrauben.
 - F Dévissez les vis.
 - E Destornille los tornillos.
- V-0101240207 P01L
 V-0101220207 P19W-P15L

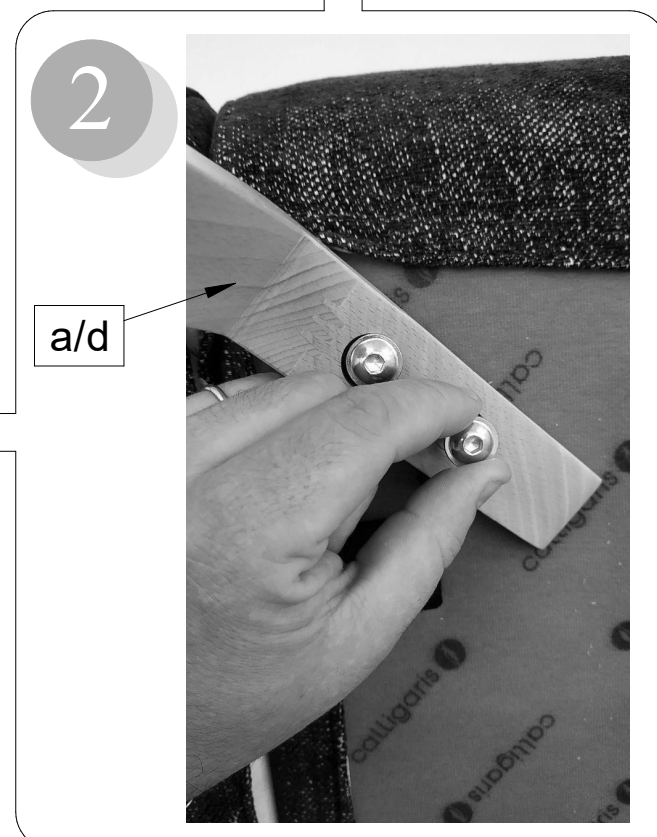
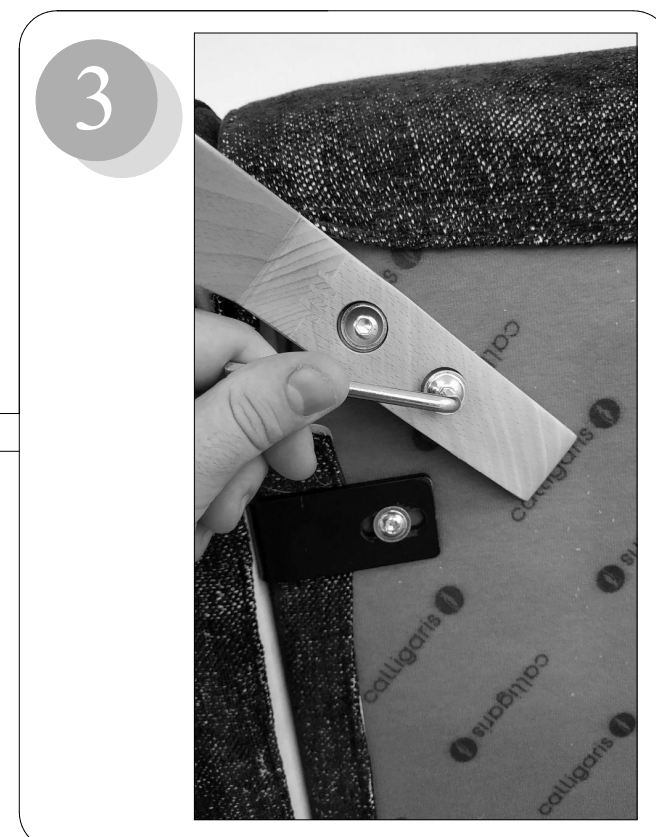
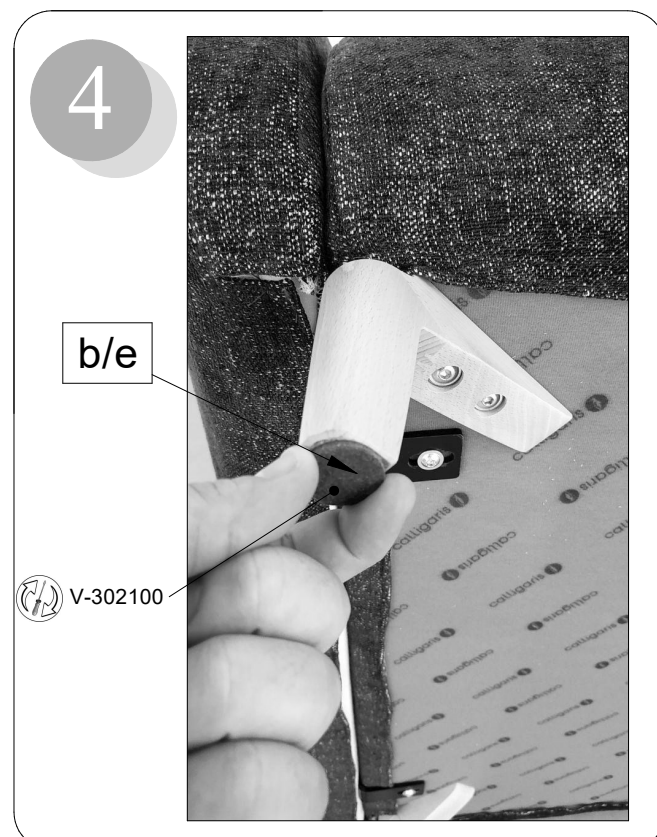

Copyright © Calligaris S.p.a. Tutti i diritti riservati - All right reserved

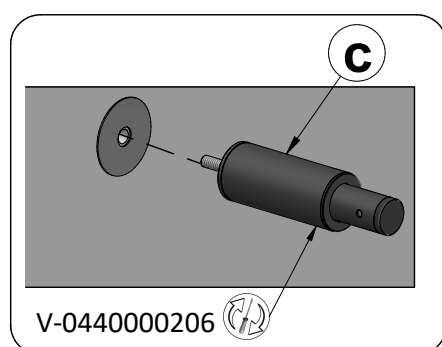

● = c

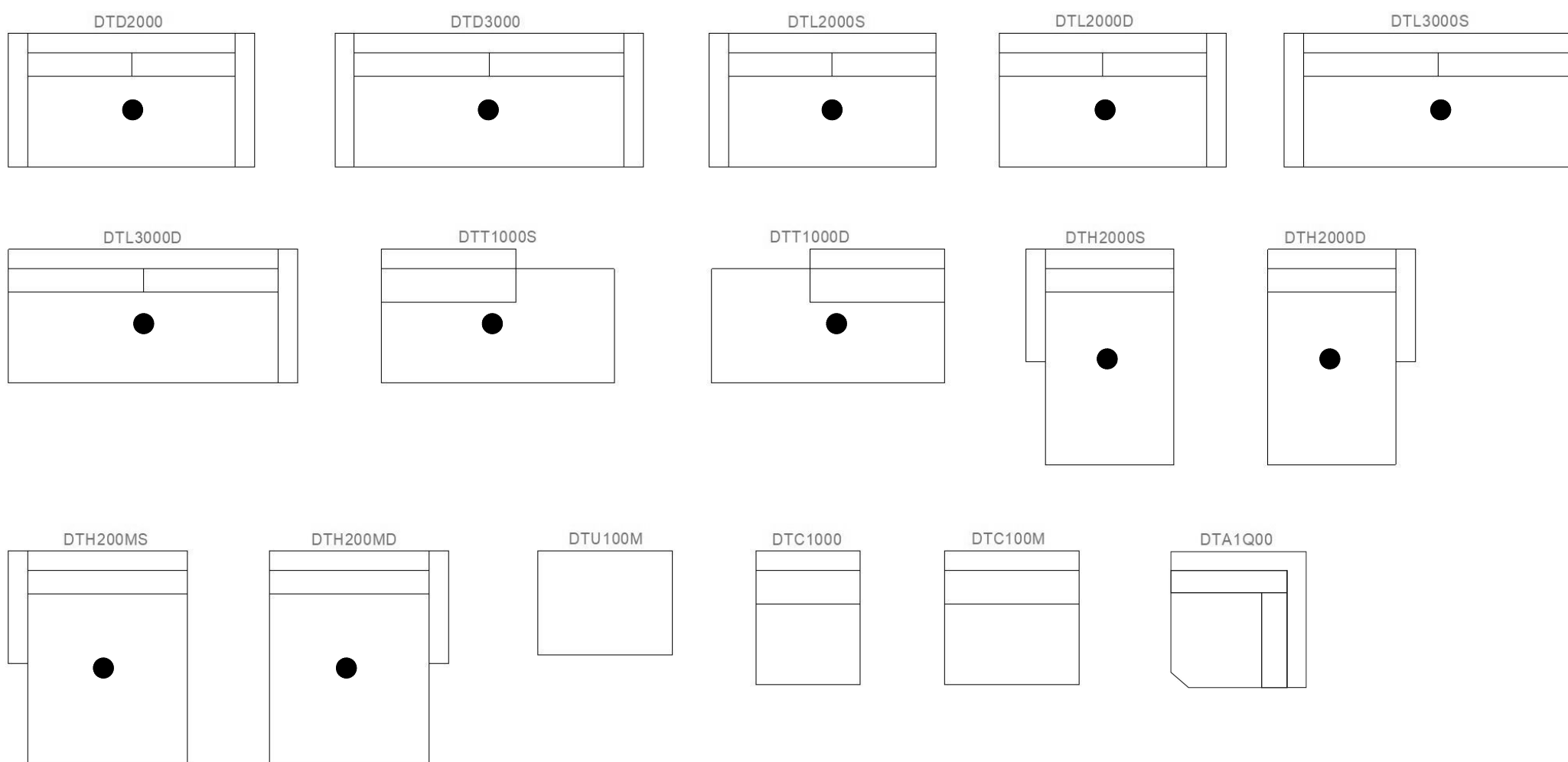

Copyright © Calligaris S.p.a. Tutti i diritti riservati - All right reserved

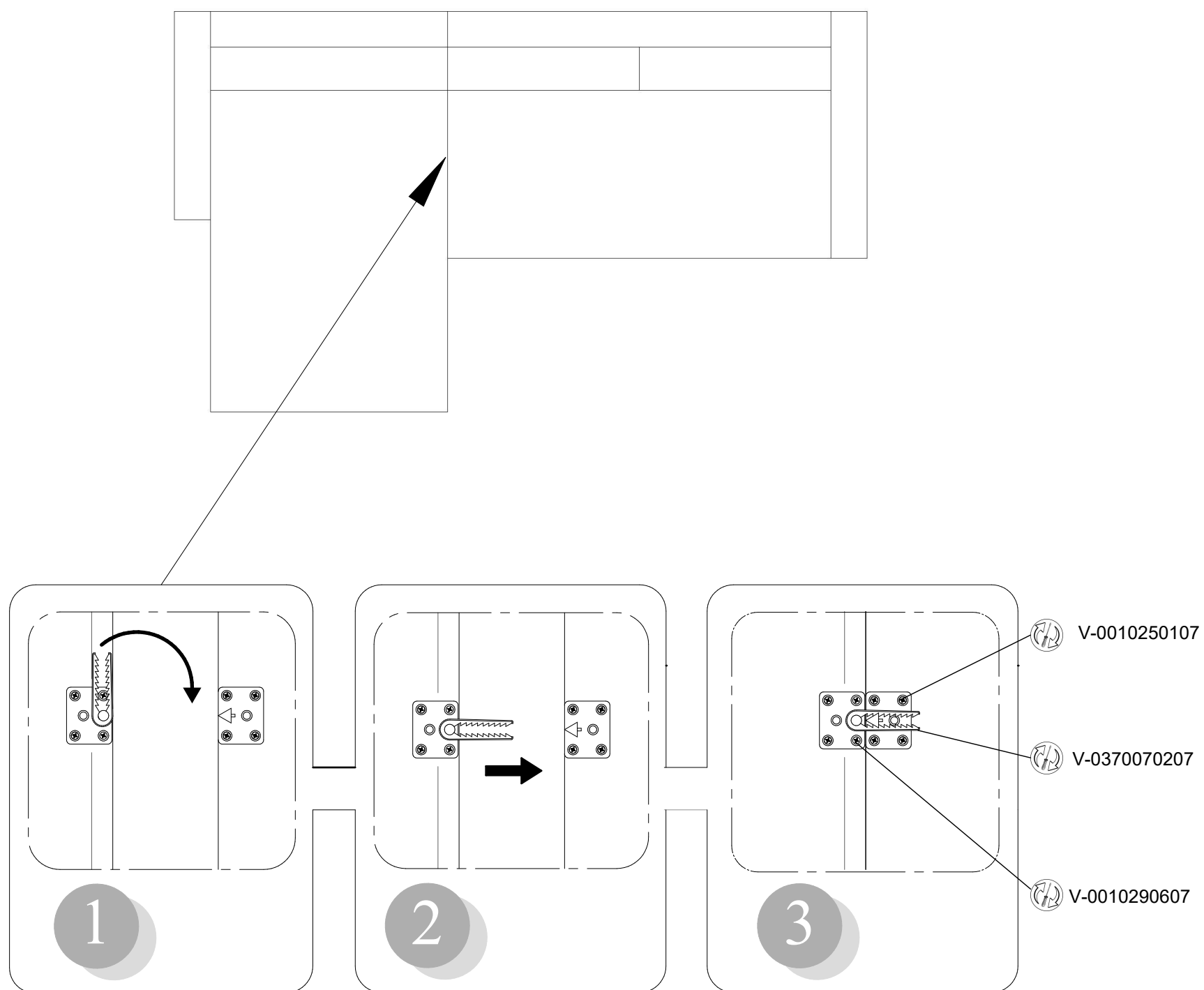

Attenzione-Attention-Vorsicht-Attention-Atención

- **I** Per sfoderare seguire le seguenti indicazioni.
- **GB** Please follow the instructions to remove the cover
- **D** Beim abziehen des Bezugs, bitte folgende Anweisungen beachten
- **F** Pour enlever la housse veuillez suivre les indications suivantes
- **E** Para desfundar seguir las siguientes instrucciones

